

GMCZ

HIGH PRESSURE JET FILTER

This HIGH PRESSURE JET FILTER is the latest product version in the air jet filter series, designed for industrial applications requiring dust separation in pressurized environments. It efficiently removes airborne particles to maintain clean air quality and protect downstream equipment. Engineered for high-performance filtration, it supports continuous operation under demanding conditions.

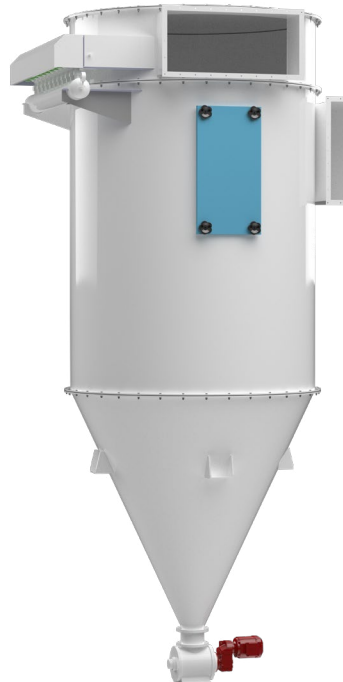

info@g-grain.com

More details please visit www.g-grain.com and download

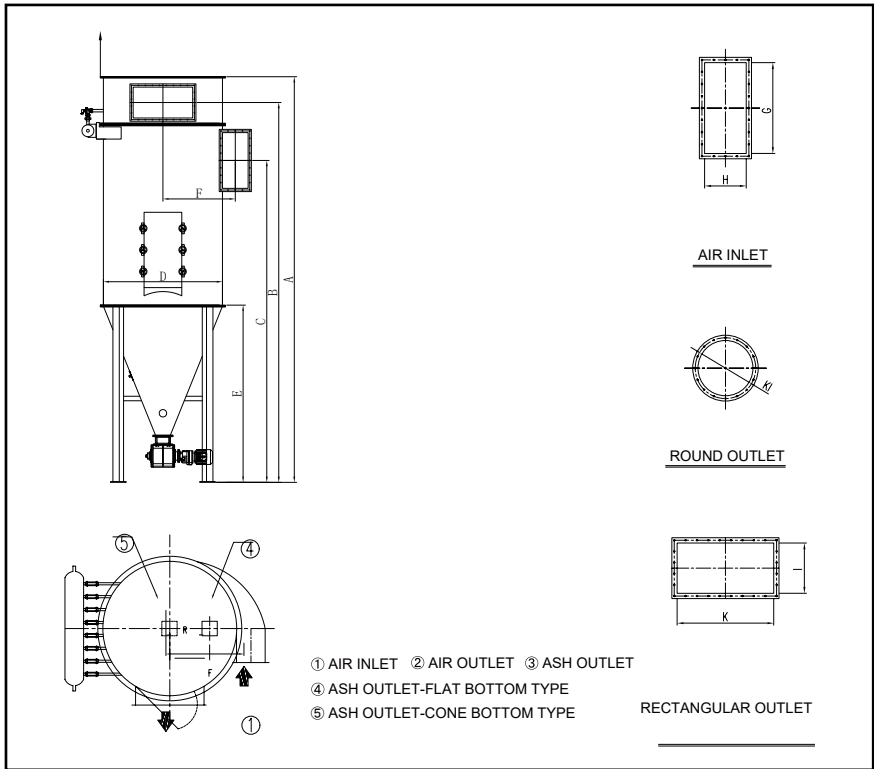

Model	Sleeve Length (mm)	Filtration Area (m ²)	Filtration Capacity (m ³ /h)	A (mm)	B (mm)	C (mm)	D (mm)	H×G (mm)	KI (mm)	Air Consumption (m ³ /min)	Pressure (bar)	Airlock (kW)
GMCZ-26/18	1800	16.9	2034-5085	4236	3951	3311						
GMCZ-26/20	2000	18.9	2269-5672	4436	4154	3511	1140	275×500	Φ450	0.08	0.4-0.6	0.75
GMCZ-26/24	2400	22.8	2739-6848	4836	4551	3911						
GMCZ-39/18	1800	25.4	3051-7627	4551	5266	3556						
GMCZ-39/20	2000	28.4	3403-8509	3751	4466	3756	1370	290×640	Φ500	0.13	0.4-0.6	0.75
GMCZ-39/24	2400	34.2	4109-10272	5151	4866	4156						
GMCZ-52/18	1800	33.9	4068-10169	4842	4557	3797						
GMCZ-52/20	2000	37.8	4538-11345	5042	4757	3997	1580	340×740	790×410	0.15	0.4-0.6	1.1
GMCZ-52/24	2400	45.7	5478-13696	5442	5157	4397						
GMCZ-78/18	1800	50.8	6101-15254	5200	4915	4133						
GMCZ-78/20	2000	56.7	6807-17017	5400	4954	4333	1840	485×785	845×460	0.17	0.4-0.6	1.1
GMCZ-78/24	2400	68.5	8218-20544	5800	5354	4733						
GMCZ-104/18	1800	67.8	8135-20338	5449	5165	4357						
GMCZ-104/20	2000	75.6	9076-22689	5649	6365	4557	2020	520×835	1090×460	0.21	0.4-0.6	1.5
GMCZ-104/24	2400	91.3	10957-27392	6049	5765	4957						
GMCZ-130/18	1800	84.7	10169-25423	5903	5618	4778						
GMCZ-130/20	2000	94.5	11345-28362	6103	5818	4978	2350	530×900	1200×470	0.49	0.4-0.6	1.5
GMCZ-130/24	2400	114.1	13696-34240	6503	6218	5378						
GMCZ-156/18	1800	101.7	12203-30507	6026	5741	4866						
GMCZ-156/20	2000	113.4	13614-34034	6226	5941	5066	2440	550×970	1200×470	0.5	0.4-0.6	1.5
GMCZ-156/24	2400	137.0	16435-41088	6626	6341	5466						

Note: The filtration velocity is generally 2-5 m/min. For better dust removal efficiency, it is recommended to select a lower filtration velocity, typically 3-4 m/min. The equipment resistance is 0.5-1.5 kPa.