

YCXM

MAGNET

This MAGNET is widely used in the grain industry to separate metal impurities from raw materials. Its core is made of rare earth permanent magnetic materials, delivering a magnetic strength of up to 2,500 Gs. The casing—available in mild or stainless steel—is designed to optimize magnetic contact as materials pass through by gravity.

With a simple structure, the unit offers easy maintenance and cleaning, making it a practical and efficient solution for grain processing operations.



info@g-grain.com

More details please visit www.g-grain.com and download

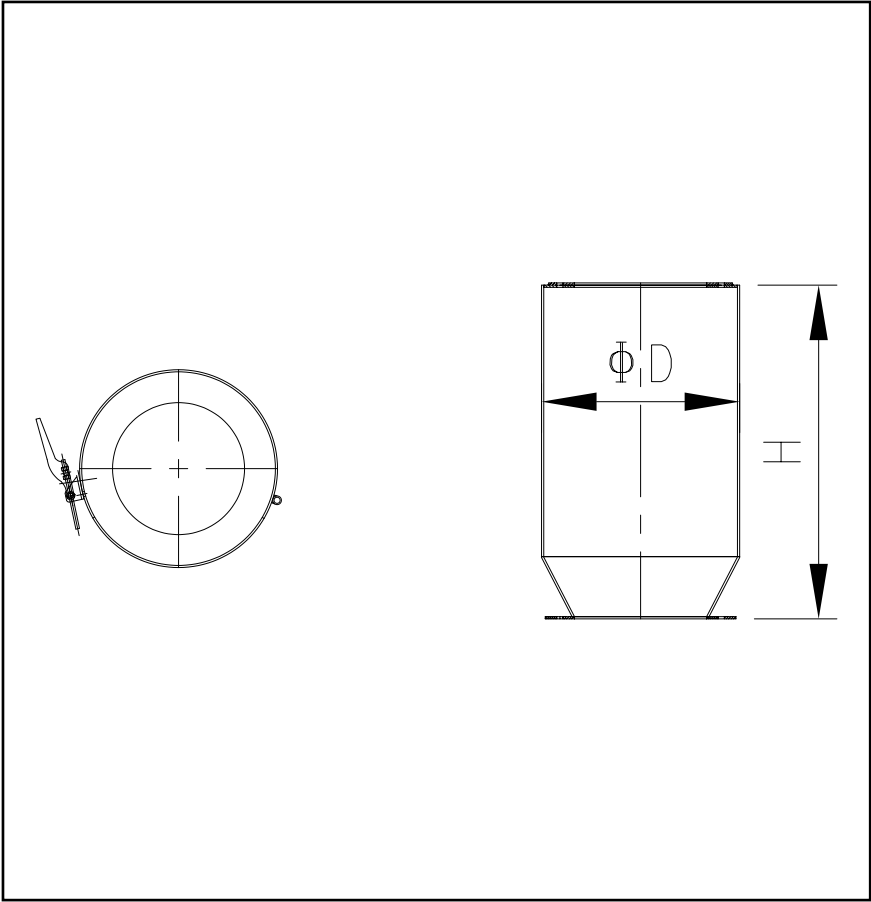

Model	Capacity (t/h)	Inlet (mm)	Magnetic Strength (GS)	Dimensions (D×H) (mm)
YCXM-10	3	Φ100	8000/10000	Φ165×400
YCXM-12	6	Φ120	8000/10000	Φ219×450
YCXM-15	10	Φ150	8000/10000	Φ250×500
YCXM-20	20	Φ200	8000/10000	Φ315×550
YCXM-25	25	Φ250	8000/10000	Φ400×600
YCXM-30	30	Φ300	8000/10000	Φ500×650
YCXM-40	35	Φ400	8000/10000	Φ680×700

Note: Capacity is based on flour with a bulk density of 550 g/L.