

JLCJ

SCREW DISCHARGE CONTINUOUS LOSS-IN-WEIGHT SCALE

Structure

Composed of a rack, feeding mechanism, weighing hopper, discharging screw, gear motor, load cell and control system.

Application

Utilized for floury materials continuous flow discharging without arching. Especially suitable for poor flow ability materials, such as continuous mixing and blending systems, continuous dough mixer etc.

Features

Continuous weighing and flexible flow adjustment, quantitative flow rate used for different working conditions; Compact structure; Lower installation height;

High capacity; Easy operation & maintenance. Rich data display for operations, profibus module, real time weighing data and reports.

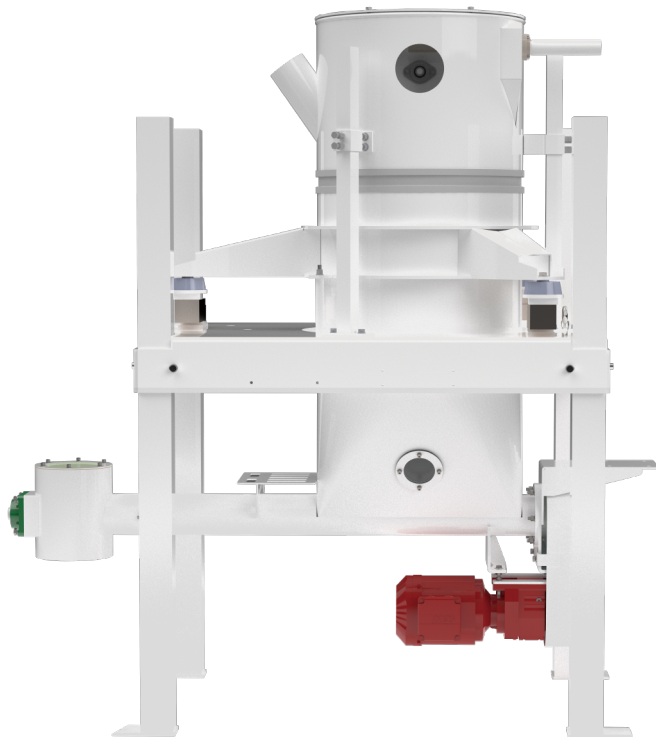

GOLDEN GRAIN

info@g-grain.com

More details please visit www.g-grain.com and download

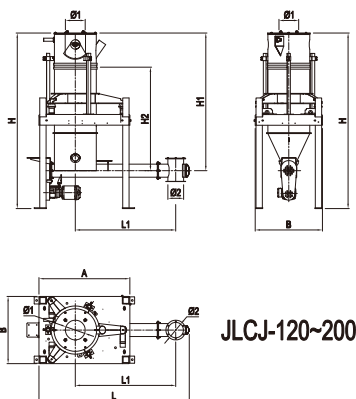

JLCJ-120~200

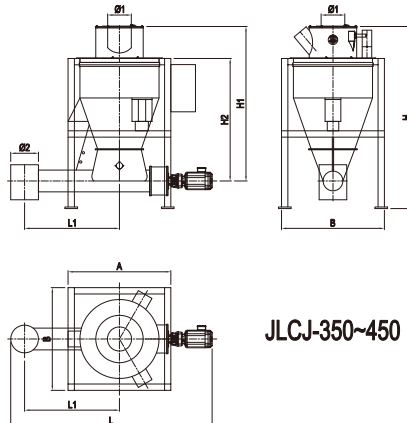

JLCJ-350~450

Loss-in weight scale dimensions table mm

Model	A	B	L1	L	H	H1	H2	Φ1	Φ2
JLCJ-120/100	1150	850	1070	1700	1902	1422	990	250	200
JLCJ-150/125	1150	850	1070	1700	2012	1532	1100	250	200
JLCJ-200/160	1150	850	1270	1900	2222	1742	1310	250	200
JLCJ-350/200	1300	1300	1200	2550	2150	1805	1400	300	250
JLCJ-450/250	1300	1300	1200	2550	2300	1955	1550	300	300

Model	Density	Scale (L)	Screw diameter	Capacity (t/h)	Accuracy	Power (kW)	Options
JLCJ-120/100	flour(0.5)	120	Φ100	0.1-3	±0.5%	1.5	screw/hopper
JLCJ-150/125	flour(0.5)	150	Φ125	0.15-5	±0.5%	1.5	screw/hopper
JLCJ-200/160	flour(0.5)	200	Φ160	0.5-15	±0.5%	2.2	screw/hopper
JLCJ-350/200	flour(0.5)	350	Φ200	1-25	±0.5%	3.0	screw/hopper
JLCJ-450/250	flour(0.5)	450	Φ250	3-45	±0.5%	4.0	screw/hopper

Accuracy 0.5% calculated according to capacity of middle and large ranges, if near the smaller range, the accuracy will exceed 0.5%