

ZGFG

POSITIVE AIRLOCK

This POSITIVE AIRLOCK feeds grain continuously or intermittently into a positive-pressure conveying pipe, where the material is carried away by air. Widely used as a feeder in flour, bran, starch, grain, feed, sugar, chemical, and plastic granular plants, it ensures efficient material transfer under pressurized conditions. An axial discharging groove beneath the casing supports smooth conveying operations and enhances system integration.

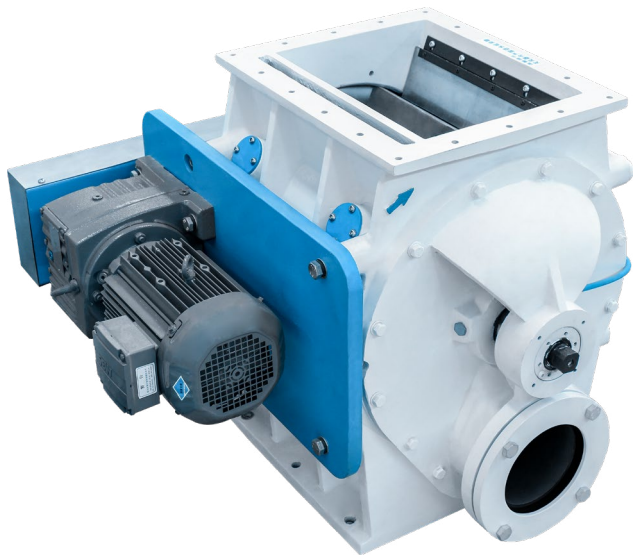

info@g-grain.com

More details please visit www.g-grain.com and download

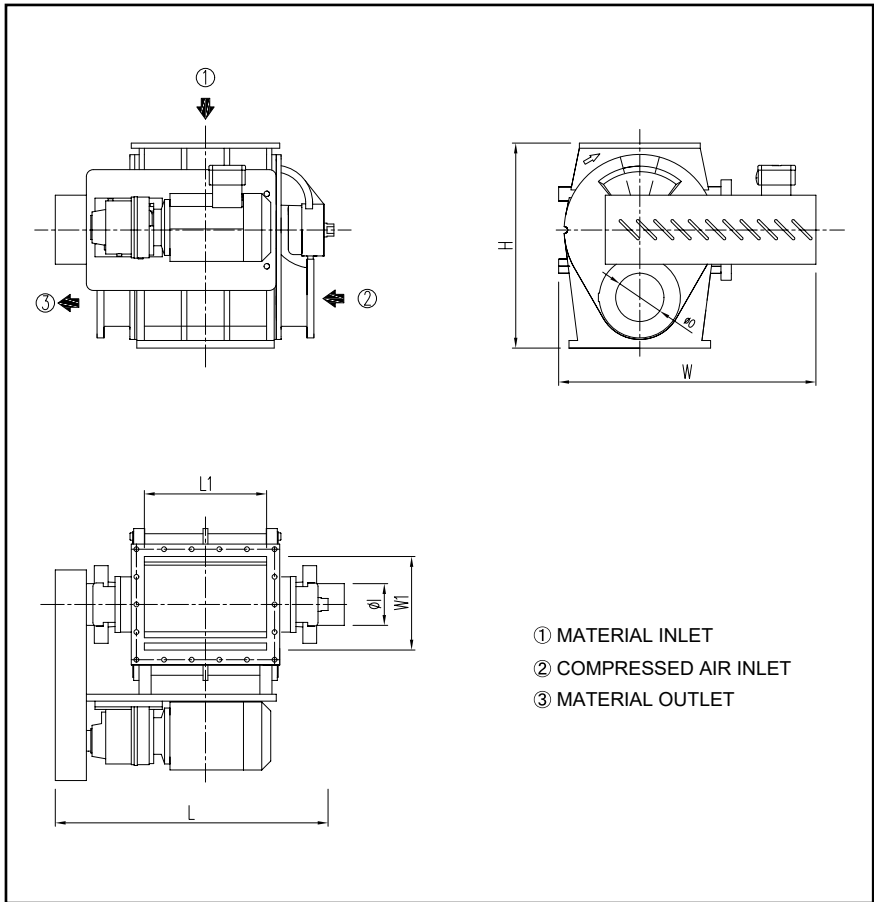

Model	Volume (m ³)	Pressure (MPa)	Rotational Speed (rpm)	Material	Capacity (t/h)	Power (kW)	Diameter (mm)	L1×W1 (mm)	Dimensions (L×W×H) (mm)
ZGFG-5.5	5.5	0.4	20-45	Flour	2-5	0.75	70	200×178	648×583×425
ZGFG-13.5	13.5		20-45	Flour	5-10	1.1	109	274×235	768×643×490
ZGFG-13.5D	13.5		20-45	Bran	2.5-5	1.1	109	274×235	768×643×490
ZGFG-28	28		20-35	Flour	11-18	1.5	156	354×271	846×765×579
ZGFG-28D	28		20-35	Bran	5-8.5	1.5	156	354×271	846×765×579
ZGFG-56	56		20-32	Flour	20-30	2.2-3	170	420×348	941×875×690