

JWL

FEEDER

This FEEDER is used to collect filter flour and residual flour from each storey of the milling system and return it for further processing. It consists of a surge hopper and screw discharger, enabling efficient consolidation and redirection of flour back into the milling flow. This helps optimize material usage and maintain consistent product quality throughout the system.



info@g-grain.com

More details please visit www.g-grain.com and download

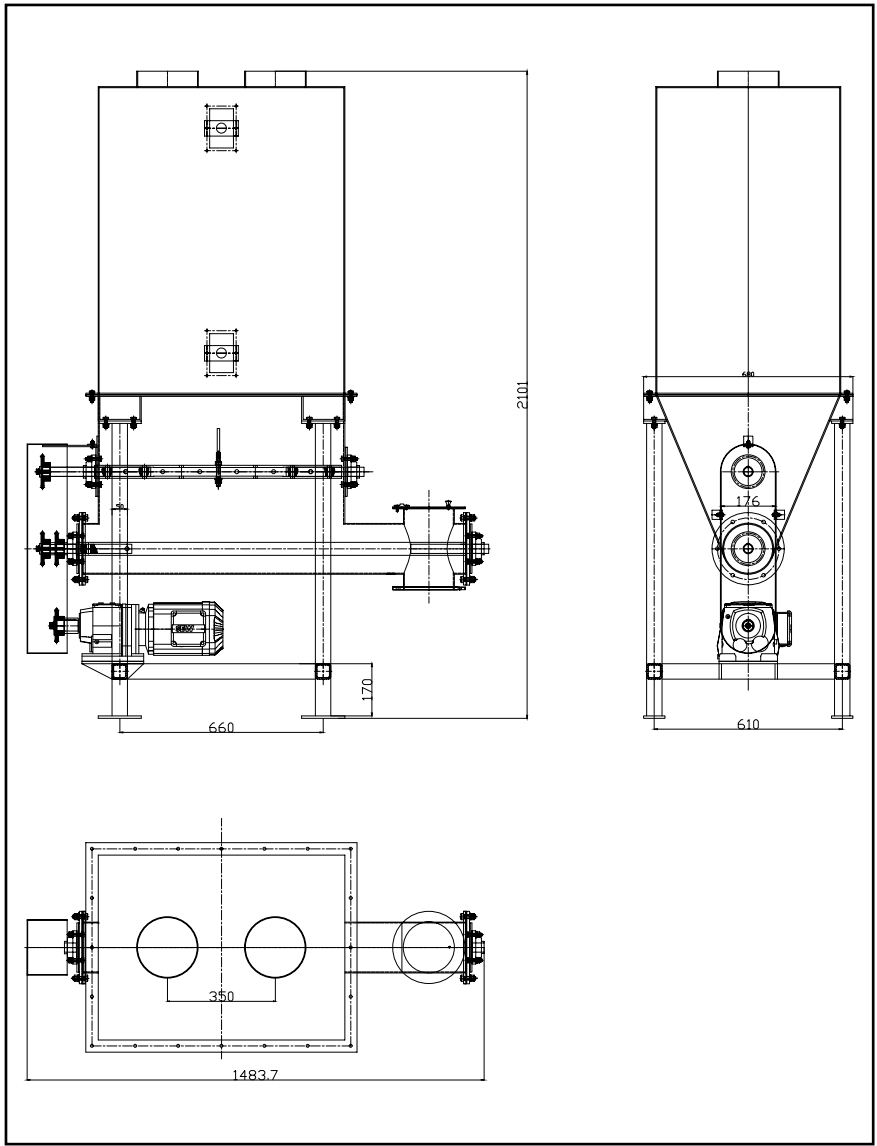

Model	Capacity (t/h)	Power (kW)	Dimensions (L×W×H) (mm)
JWL-16	0.1-1.0	1.5	1484×680×2101