

RTJS/J JTJS/J

RTJS/J INGREDIENT FEEDER JTJS/J LOSS-IN WEIGHT FEEDER

RTJS/J-additive feeder, belongs to the volumetric discharge feeder category, feed rate control is according to the screw diameter and speed, equipped with speed controller. Composed of hopper, single screw or double screw, double shaft transmission gearbox, gear motor or servo motor etc. Standard configuration is a single screw, with double screw used for viscous materials. The hopper is equipped with an agitator to prevent the material from caking. Using servo motor, the screw speed adjustable range is larger, therefore more flexible.

JTJS/J-loss-in weight additive feeder belongs to the continuous discharge loss-in weight scale category. Speed of gear motor by frequency converter or by servo motor for flow rate. Composed of hopper, single screw and double screw, double shaft transmission gearbox, gear motor or servo motor etc. Standard configuration is single screw, double screw is used for viscous materials, hopper is equipped with agitator to prevent the material from caking. Using servo motor the screw speed adjustable range is larger, flow regulation is more flexible.



info@g-grain.com

More details please visit www.g-grain.com and download

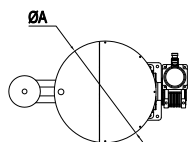
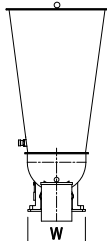
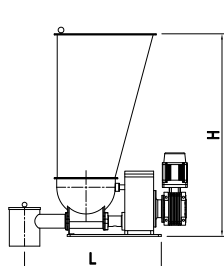

Volumetric type

Model	L	W	H	ØA
RTJS/J-20	492	200	572	340
RTJS/J-28	543	235	837	530
RTJS/J-38	563	255	929	530
RTJS/J-46	712	300	1056	530

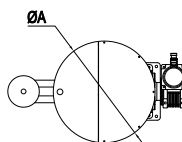
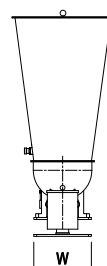
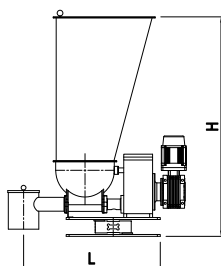

Loss-in-weight type

Model	L	W	H	ØA
JTJS/J-20	492	200	661	340
JTJS/J-28	543	235	925	530
JTJS/J-38	563	255	1018	530
JTJS/J-46	712	300	1144	530

Model	Description	Screw Dia. (mm)	Single Screw flow (L/h)	Twin Screw flow (L/h)	Power (kW)	Motor	
						Gear	Servo
RTJS/J-20	Volumetric Feeder	20	1-40	1-60	0.4	Optional	Optional
RTJS/J-28	Volumetric Feeder	28	5-100	30-350	0.75	Optional	Optional
RTJS/J-38	Volumetric Feeder	38	30-300	50-1400	1.1-1.5	Optional	Optional
RTJS/J-46	Volumetric Feeder	46	150-800	300-1800	1.5	Optional	Optional
JTJS/J-20	Loss-in weight Feeder	20	1-40	1-60	0.4	Optional	Optional
JTJS/J-28	Loss-in weight Feeder	28	5-100	30-350	0.75	Optional	Optional
JTJS/J-38	Loss-in weight Feeder	38	30-300	50-1400	1.1-1.5	Optional	Optional
JTJS/J-46	Loss-in weight Feeder	46	500-800	300-1800	1.5	Optional	Optional